



ENGEL

SERVICE MANUAL

MODEL :

MT60F-U1 0642 060 1R21

MT60F-U1-C 0642 060 2R00

MT80F-U1-S 0642 080 1R01

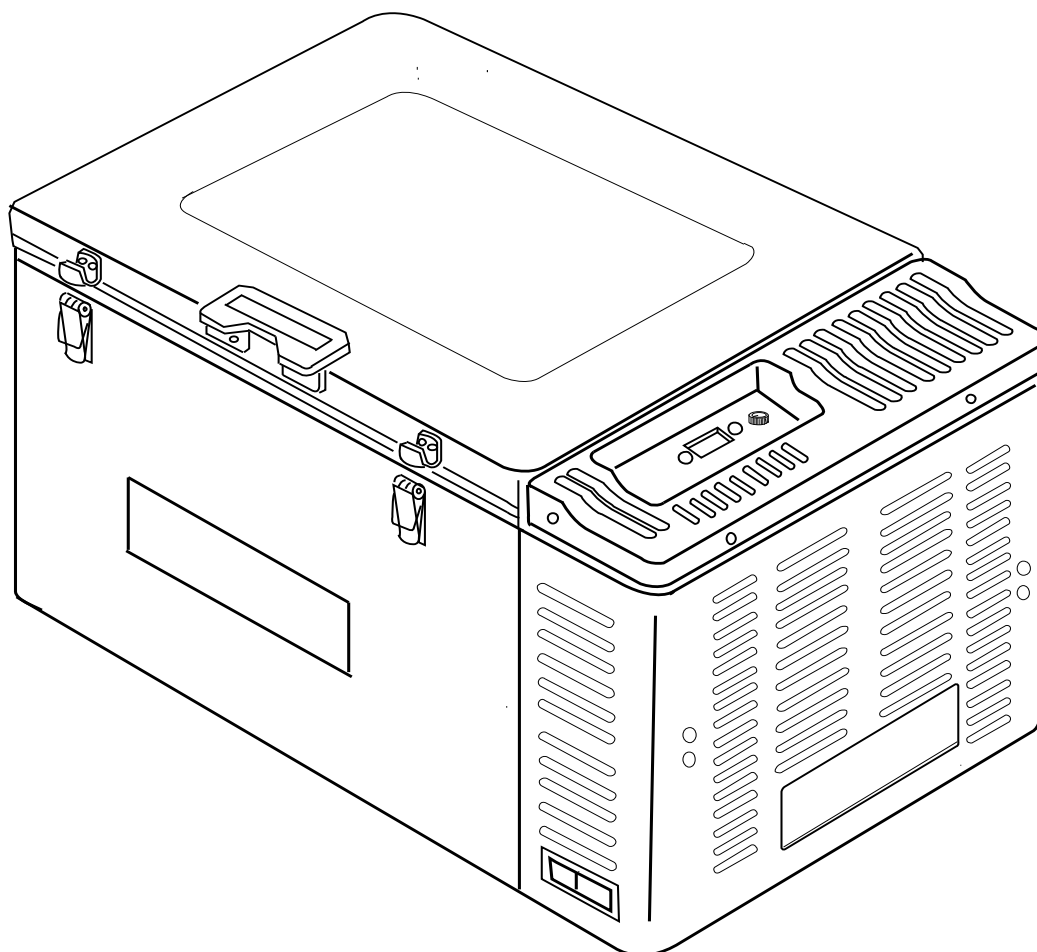

TABLE OF CONTENTS

1. SPECIFICATIONS	1
1-1 Specifications Table	1
1-2 Dimensions (MT60F-U1 / MT80F-U1-S)	2
1-3 Dimensions (MT60F-U1-C)	3
2. WIRING DIAGRAM	4
2-1 Block Diagrams	4
2-2 Wiring Diagrams	4
3. PART NAME	5
3-1 Parts name (MT60F-U1 / MT80F-U1-S)	5
3-2 Parts name (MT60F-U1-C)	6
4. INSTALLATION	7
4-1 How to Install the Refrigerator	7
5. TROUBLE SHOOTING	8~10
■ Does not get Cold	8
■ Cooling is Weak	9
■ Refrigerator is too cold	10
■ Compressor keeps turning on and off at short intervals ..	10
6. CHECKING POINTS & MEASUREMENT	11~12
【Check 1】 Fuse	11
【Check 2】 Input Voltage of the Compressor	11
【Check 3】 Check the Resistance at the Coil of Compresso	11
【Check 4】 Resistance of Thermistor	11
【Check 5】 Resistance of Control Assy	12
【Check 6】 Check the temperature controller	12
【Check 7】 Checking the operation of the fan motor	12
7. REPLACEMENT PROCEDURES	13~17
■ How to Replace Cooling Unit	13
■ How to Replace Power Supply	15
■ How to Replace Control Assy and Digital Thermometer	16
■ How to Replace Fan Motor	17

1. SPECIFICATIONS

■ Specifications Table

MODEL		MT60F-U1	MT80F-U1-S	MT60F-U1-C
STORAGE VOLUME	liter	60	80	25 (Freezing side) 32 (Refrigerator side)
EXTERNAL DIMENSIONS WxDxH	in	31.6 × 20.5 × 17.4	31.6 × 20.5 × 22.1	31.6 × 20.5 × 17.4
	mm	802 × 520 × 441	802 × 520 × 561	802 × 520 × 441
INTERNAL DIMENSIONS WxDxH	in	20.4 × 14.9 × 12.4	20.2 × 16.1 × 14.8	8 × 15 × 12.5 (FREEZER) 10 × 15.5 × 12.5 (FRIDGE)
	mm	517 × 378 × 315	514 × 410 × 375	205 × 378 × 315 (FREEZER) 260 × 400 × 315 (FRIDGE)
OUTER ENCLOSURE	DOOR	Cold rollomng steel sheet. (Melamine baking finish)		
	CABINET			
INNER ENCLOSURE	DOOR	ABS resin		
	CABINET			
HEAT INSULATOR	DOOR	Foamed Polyurethane		
	CABINET			
INPUT VOLTAGE	AC	120V		
	DC	12V / 24V		
RATED AMPERAGE	AC	1.2A		
	DC	4.2A / 2.1A		
COMPRESSOR RATING		AC 16 V, 3A 48W		
REFRIGERANT		Dichlorodifluoromethane (HFC-134a)		
AVERAGE INNER TEMPERATURE (at ambient temp 30°C)		7°C±3°C (with dial notch at '1')		
TEMPERATURE CONTROL DIAL AT '5' OR ABOVE (at ambient temp 30°C)		lees than -18 °C		<Refrigerator side> must be MAX5°C MIN-
				<Freezing side> lees than -18 °C
TEMPERATURE CONTROL		Digital temperature control with electronic thermostat		
WEIGHT	LBS.	72	86	73
	Kg	32	39	33

1. SPECIFICATIONS

■ Dimensions (MT60F-U1 / MT80F-U1-S)

Unit (mm)

※ Tolerance is omitted

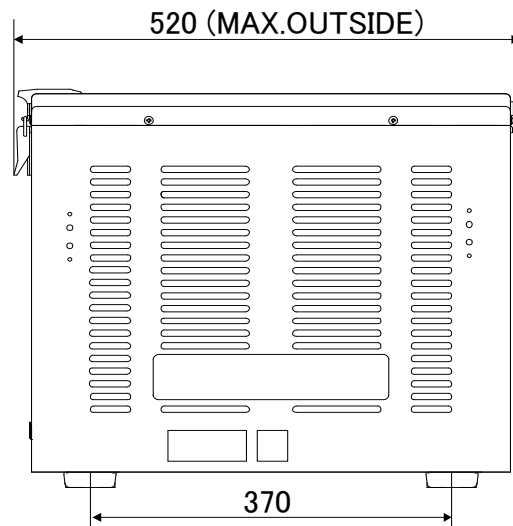
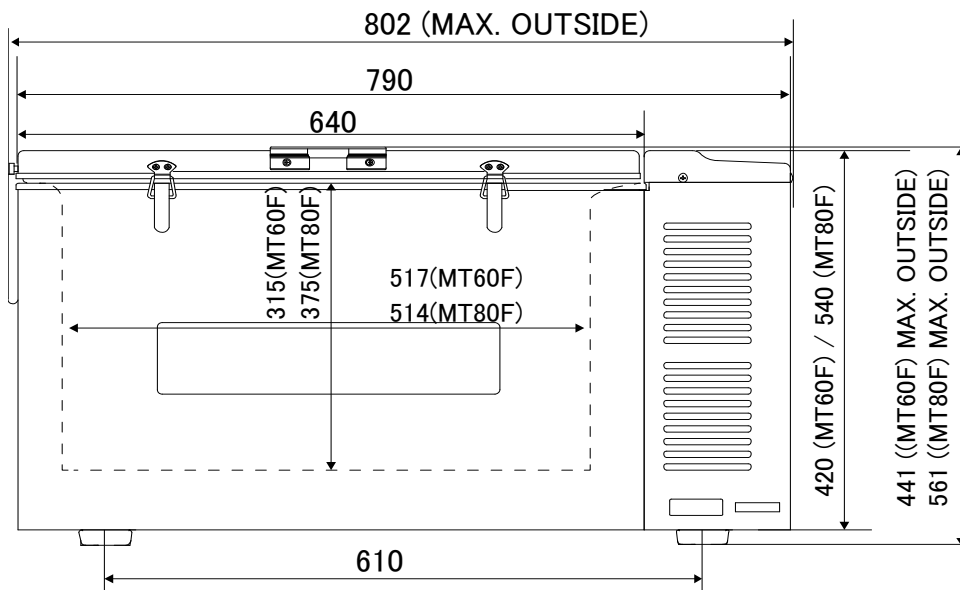
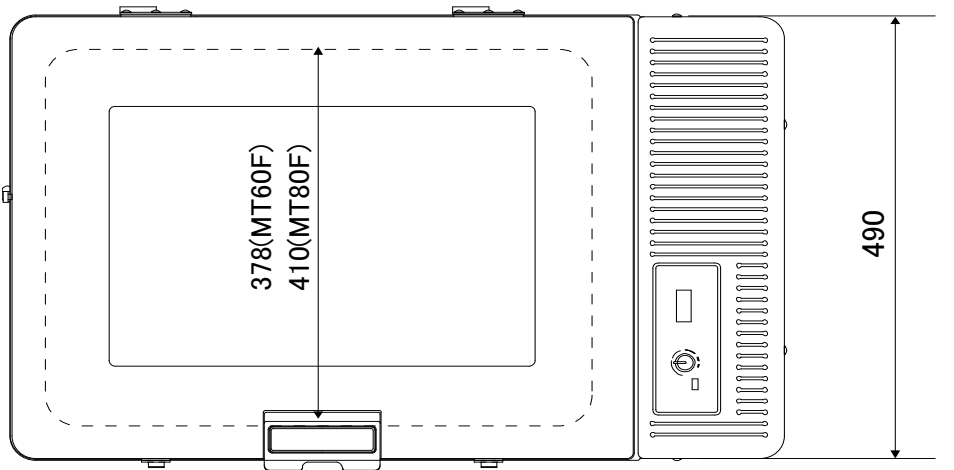

1. SPECIFICATIONS

■ Dimensions (MT60F-U1-C)

Unit (mm)

※ Tolerance is omitted

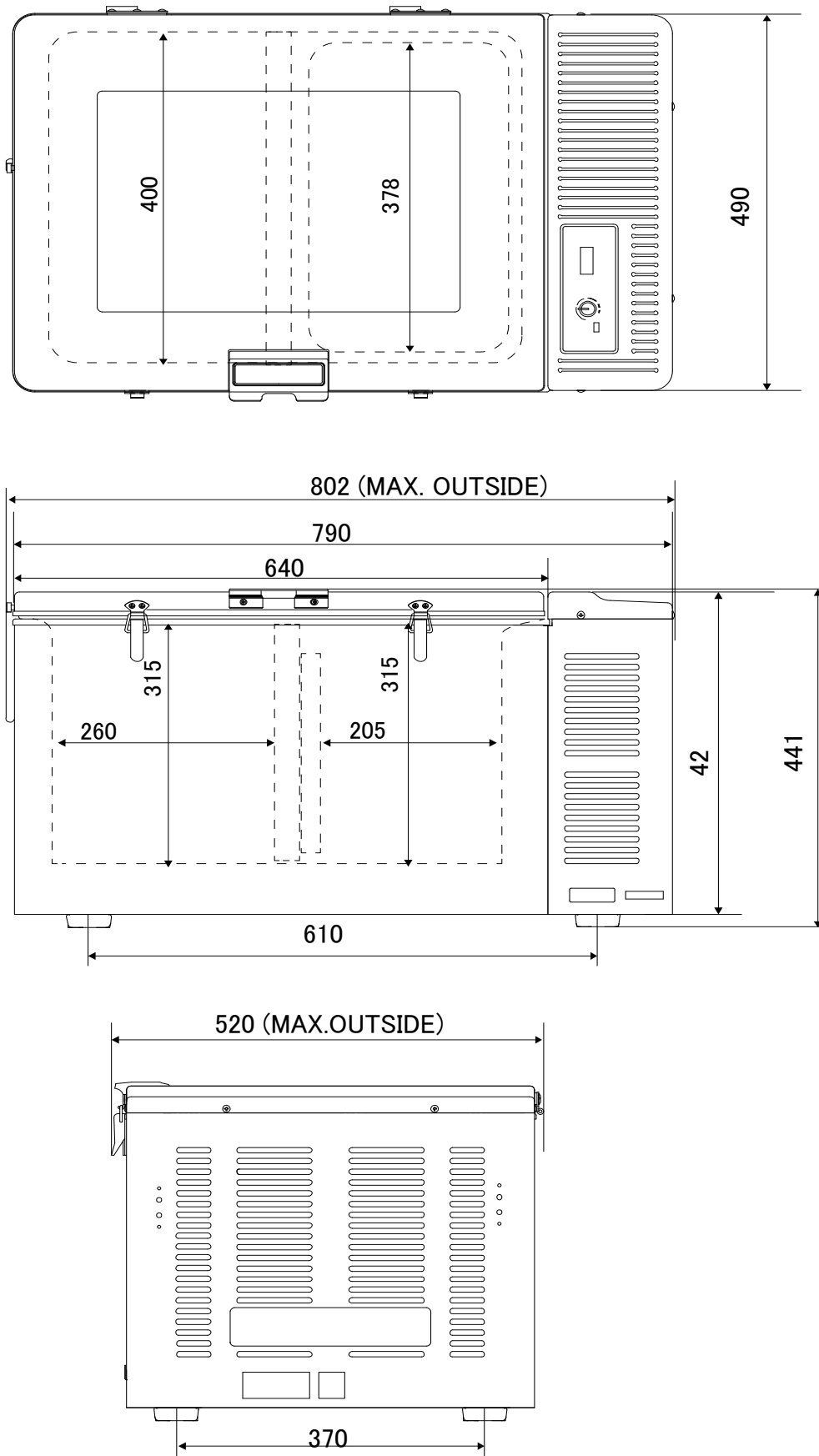

2. WIRING DIAGRAM

● Block Diagrams

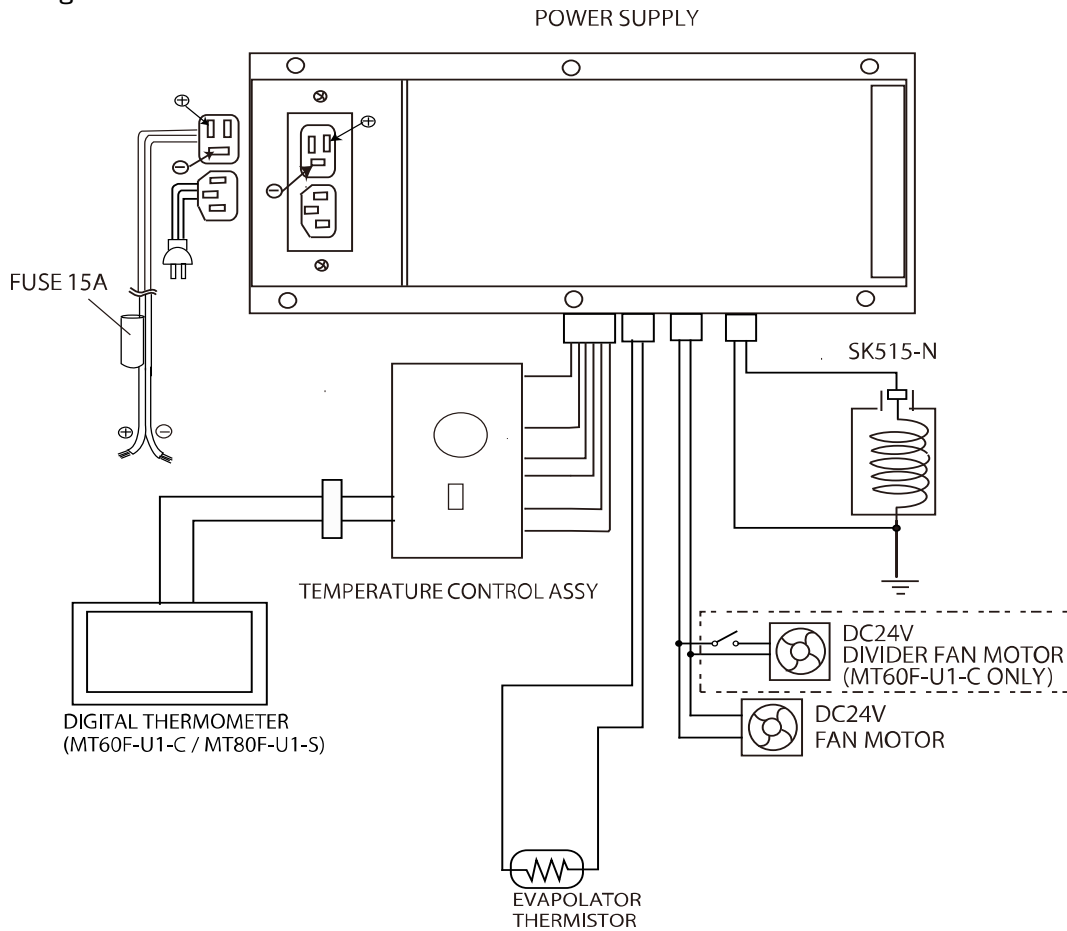

● Wiring Diagrams

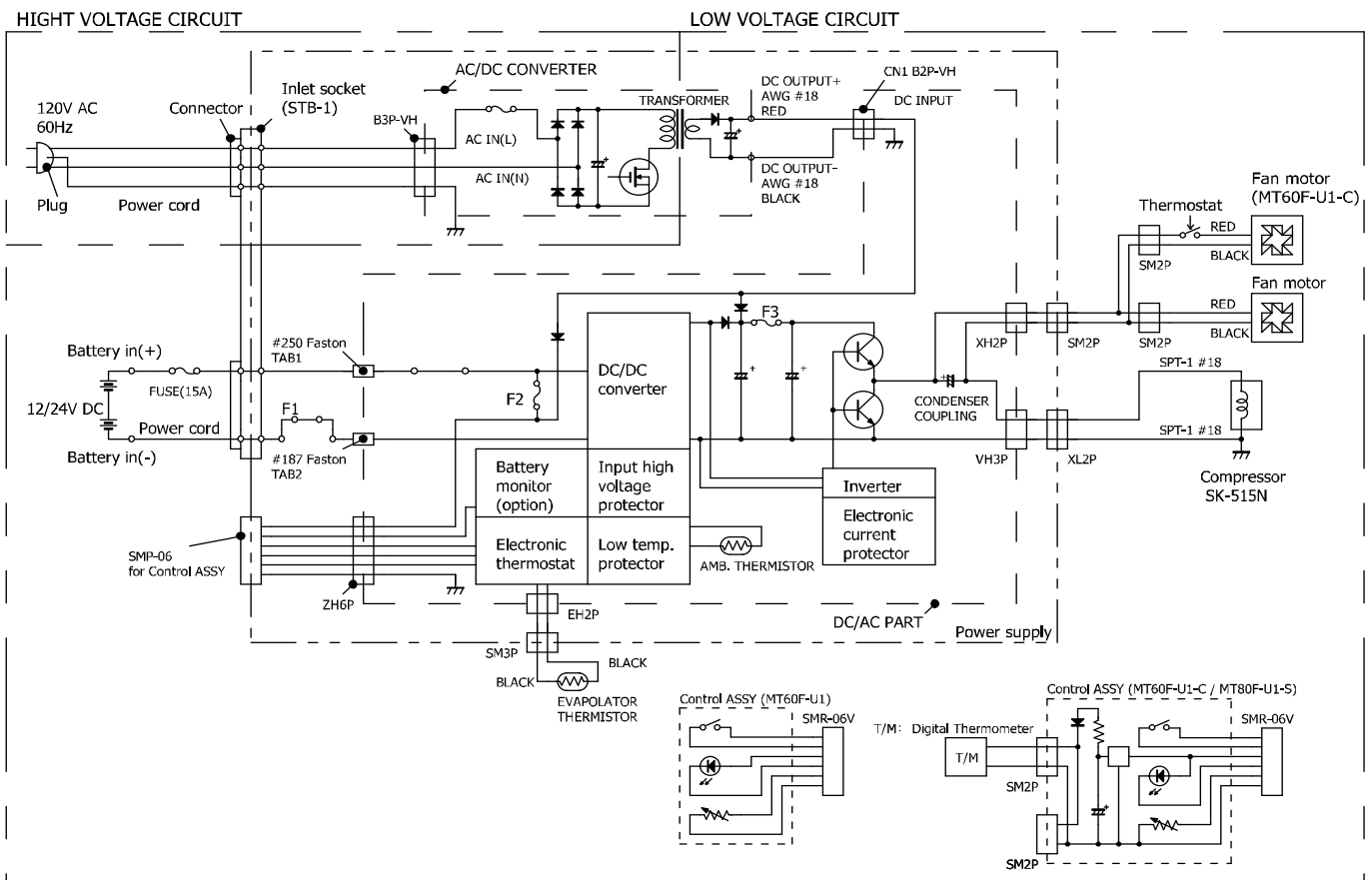

3. PARTS NAME

■ Parts name (MT60F-U1 / MT80F-U1-S)

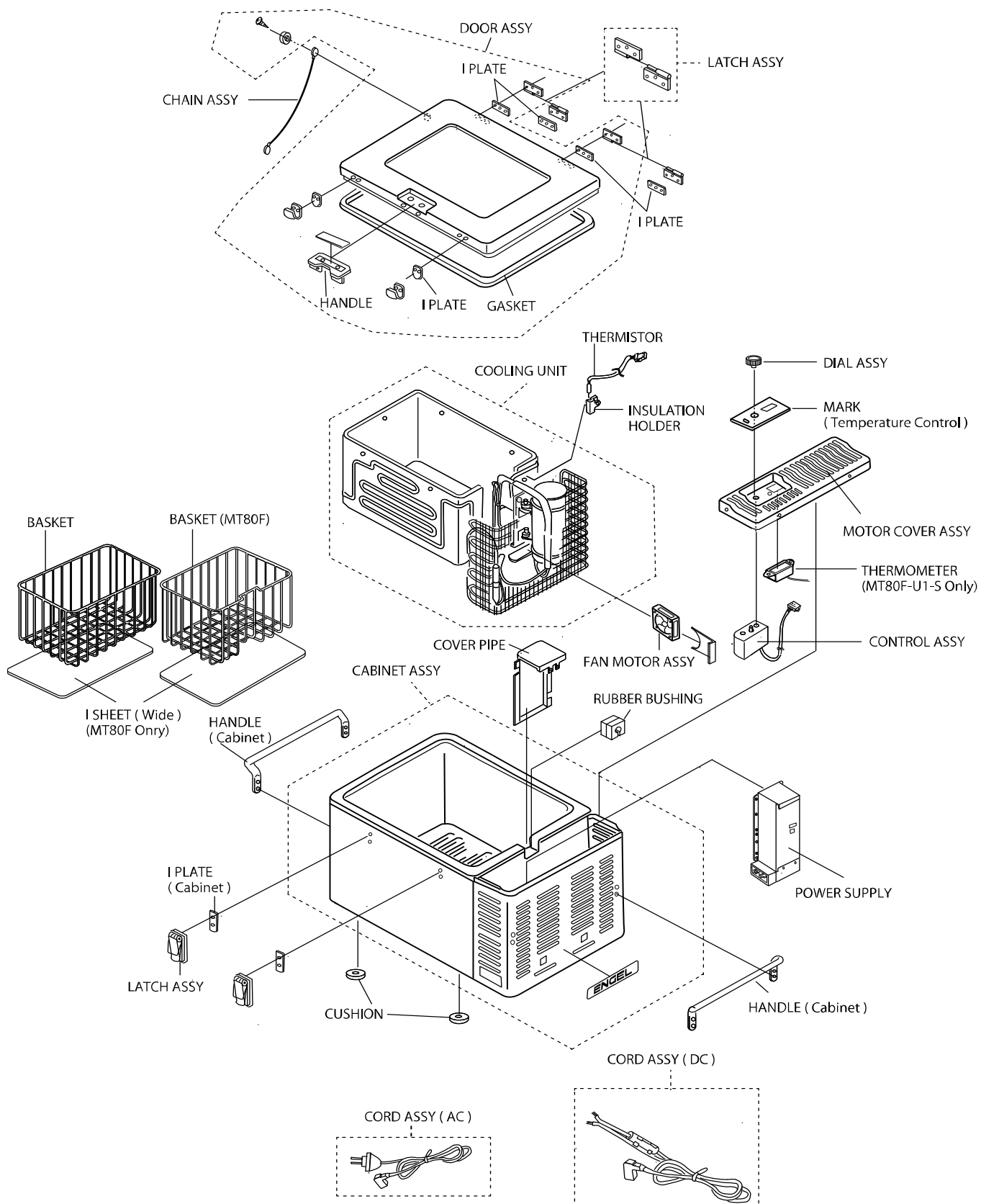

3. PARTS NAME

■ Parts name (MT60F-U1-C)

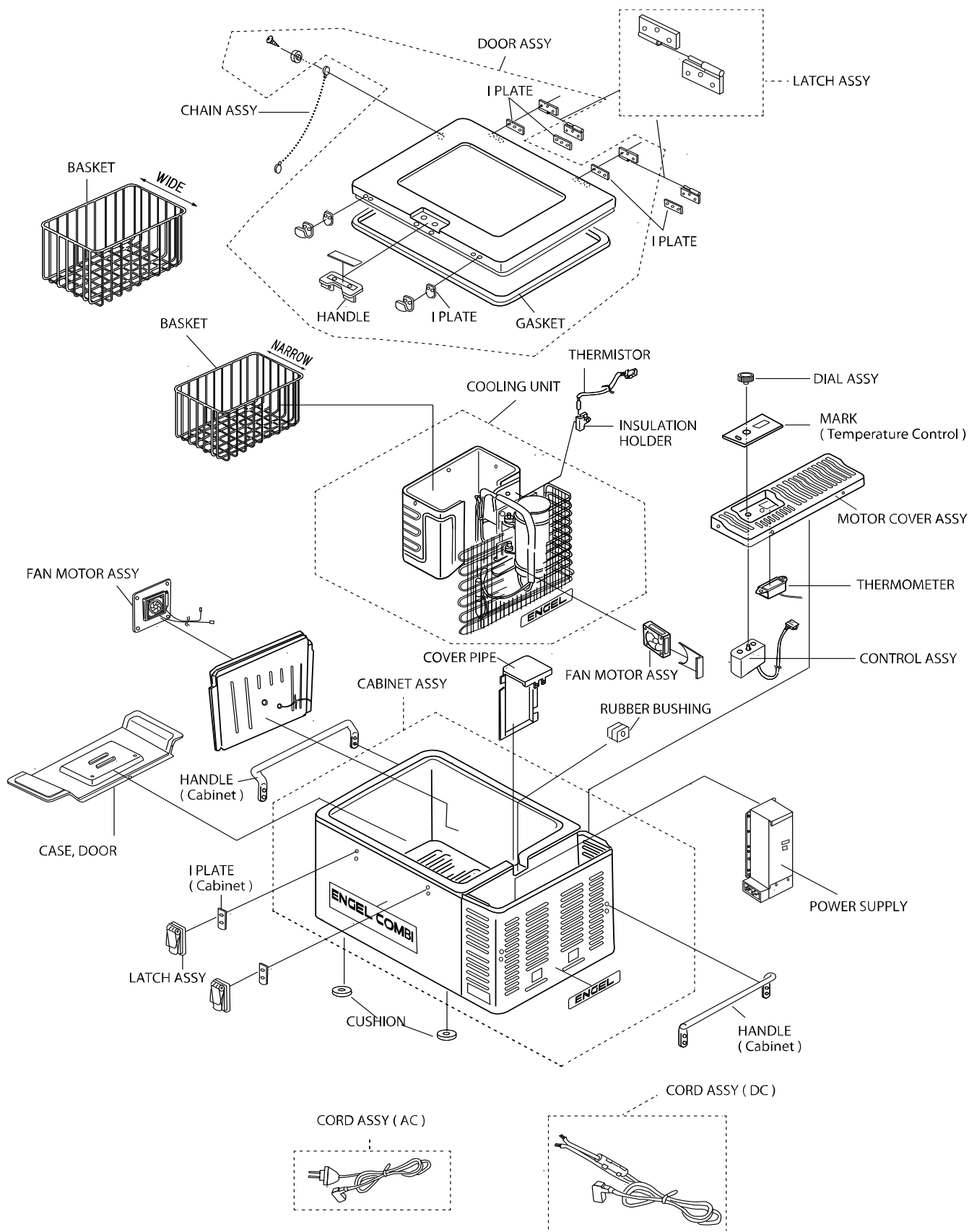

4. INSTALLING A REFRIGERATOR

■ How to Install the Refrigerator.

- (1) Your shockproof fridge is best installed on a solid surface.
- (2) Be sure your fridge is not placed near a gas stove, heater or other heat-generating appliances.
- (3) Adequate ventilation and suitable distance from each wall (at least 150mm or more) is necessary for the maximum cooling efficiency and minimum electric current consumption for "free standing use" (see Fig. shown below).
- (4) Avoid installing your fridge close to kitchen sink or faucet.
- (5) If you use the fridge under the counter or in the fixing box, please note the following air ventilation conditions.
 - 1) Make vent opening both under fridge or bottom and above fridge top cover.
 - 2) Vent opening size must be larger than 160cm^2 for each opening
(the more air circulation over the condenser, the more efficiently fridge will operate).

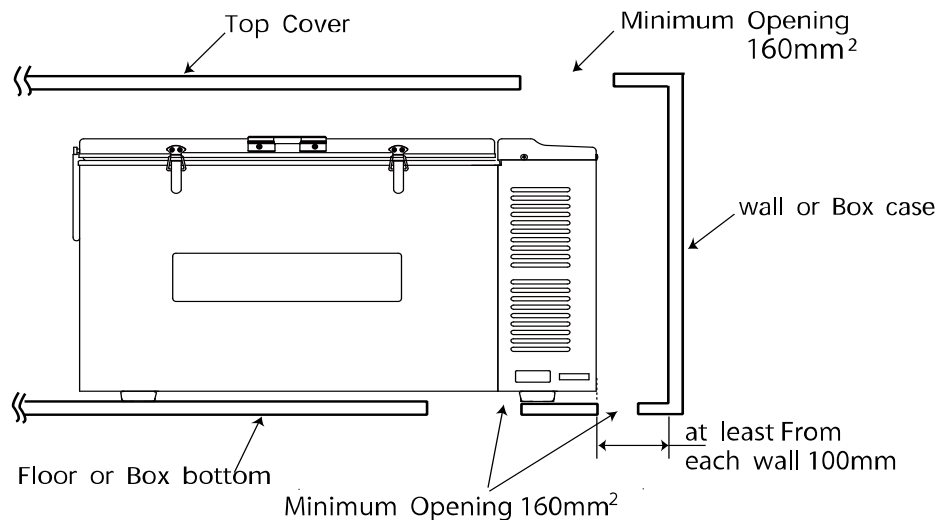

WORK TIPS

Failure to provide the necessary venting will result in poor refrigeration, continuous compressor operation, accelerated battery discharge and sometimes shorten the life of fridge.

5. TROUBLE SHOOTING

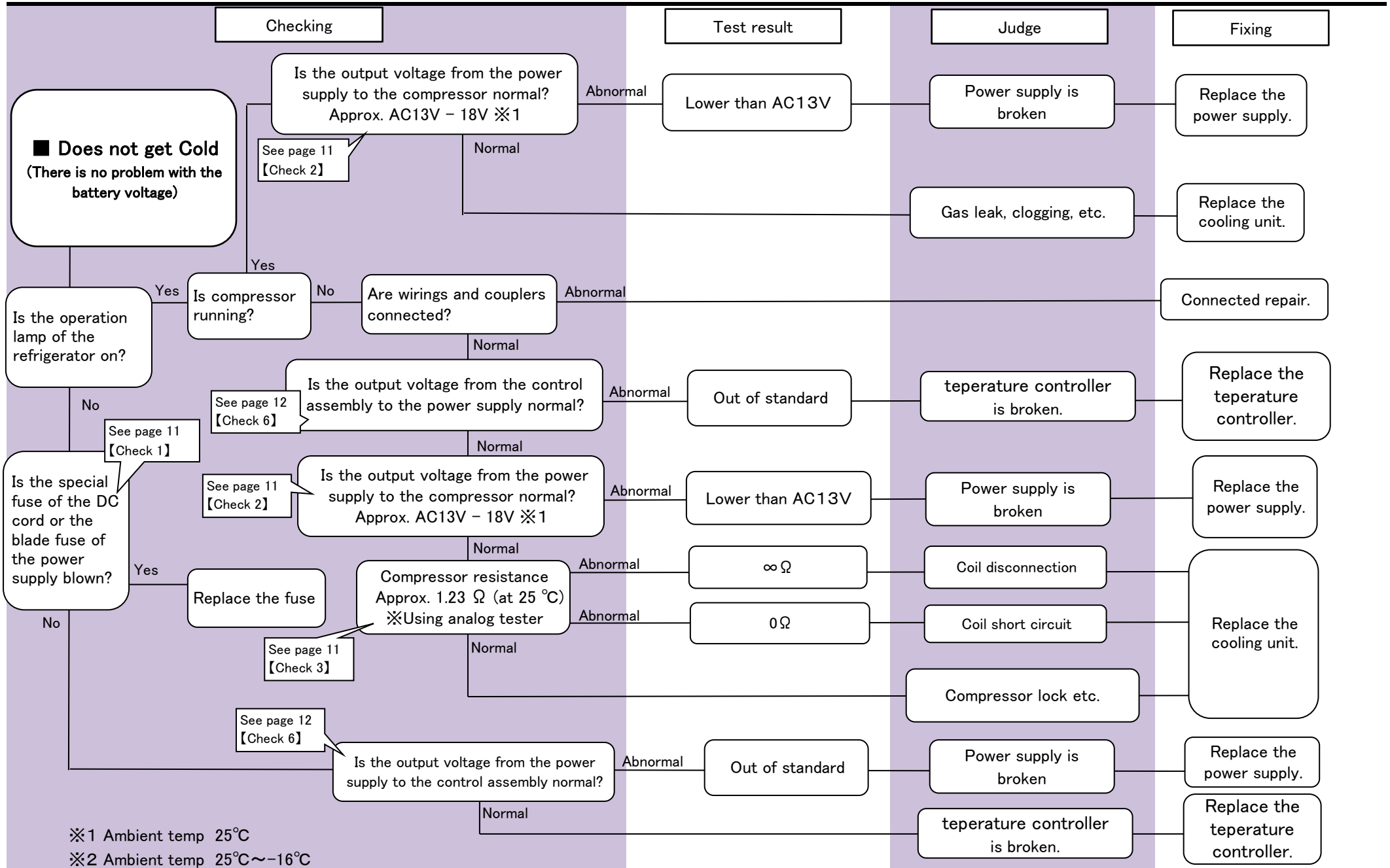

5. TROUBLE SHOOTING

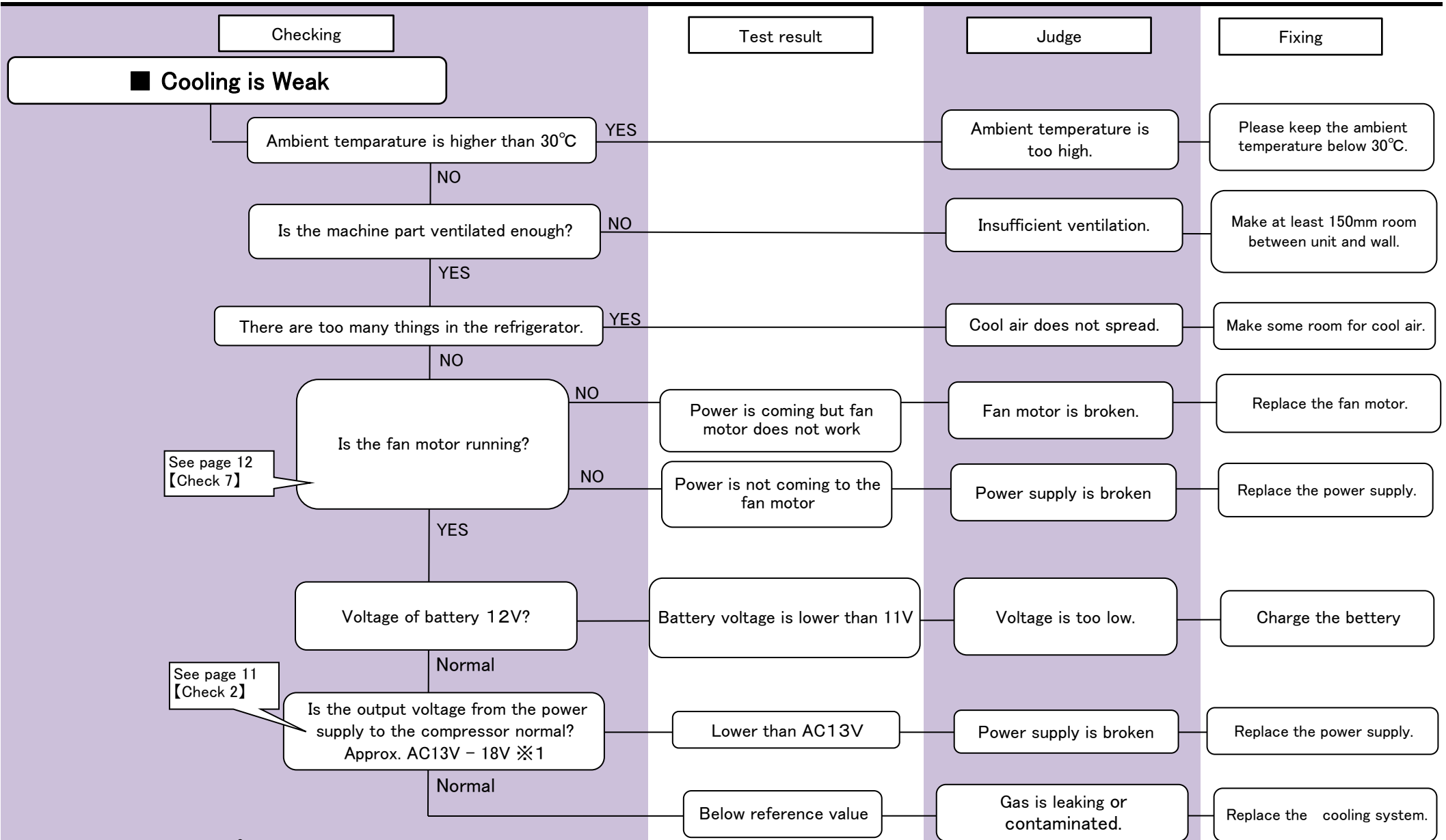

※1 Ambient temp 25°C

5. TROUBLE SHOOTING

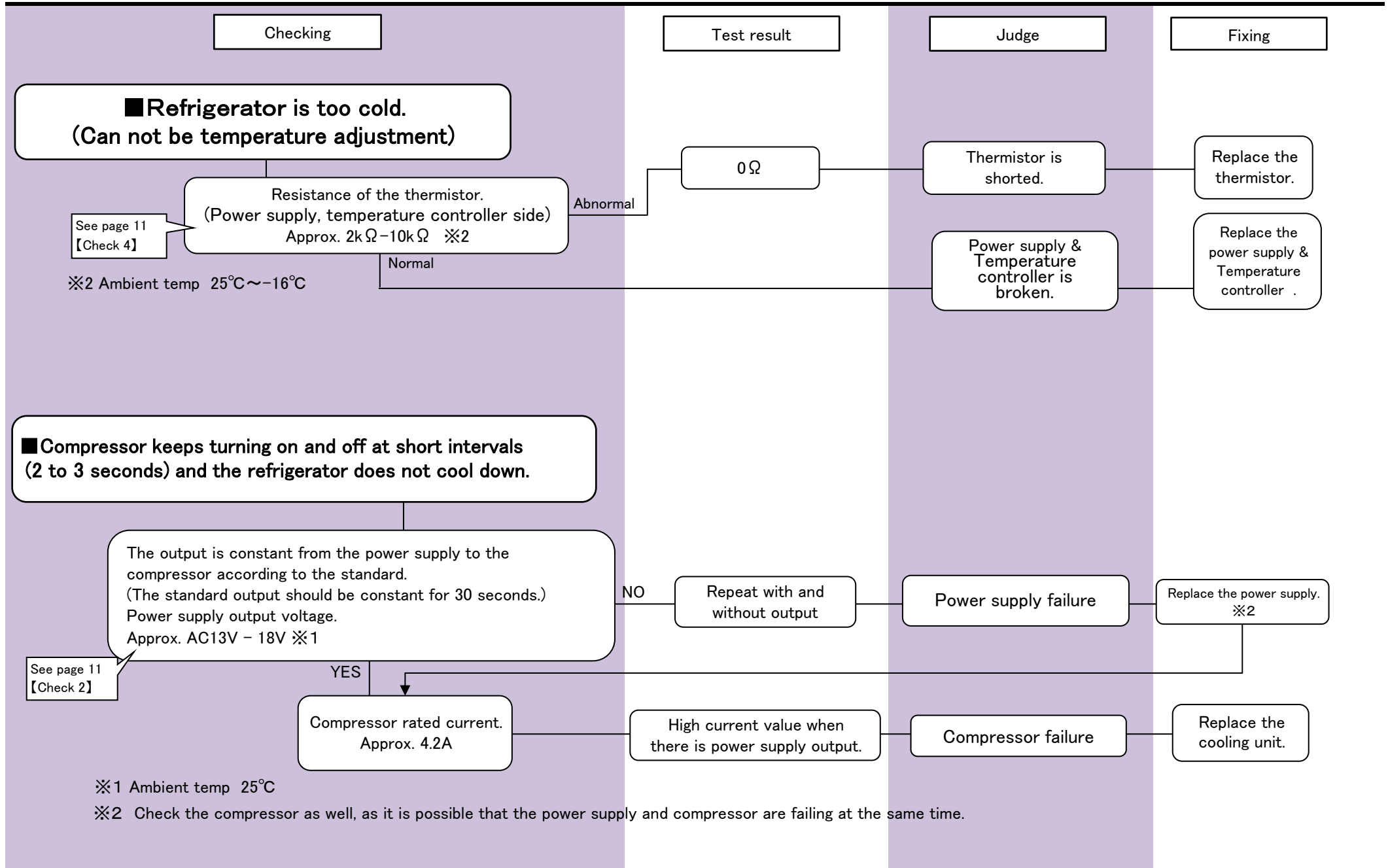

※1 Ambient temp 25°C

※2 Check the compressor as well, as it is possible that the power supply and compressor are failing at the same time.

5. CHECKING POINT & METHOD

【Check 1】 Fuse (Fig.1)

◇ Check the resistance of fuse by tester.

Test result	Assessment
0 Ω	Normal
∞ Ω	Broken

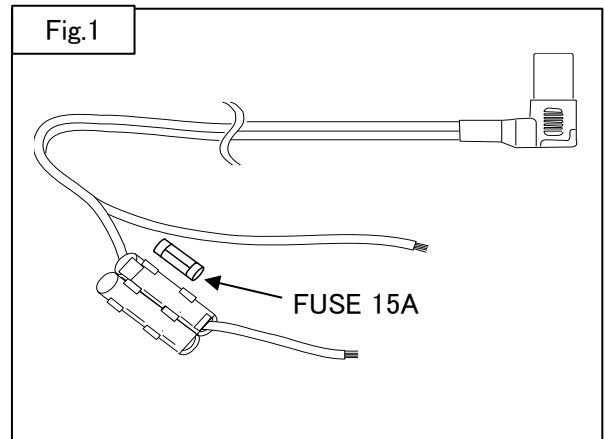

【Check 2】 Input Voltage of the Compressor (Fig.2)

◇Checking point

- Check at 2 pin coupler of Inverter (Fig.2) or at input terminals of the compressor.
(Should be checked when the compressor is connected)
(Ambient temp 25°C)

Test result	Assessment
Approx. AC13~18V	Normal
AC 0 V	Inverter is broken
Approx. AC13V or lower	Compressor is locked

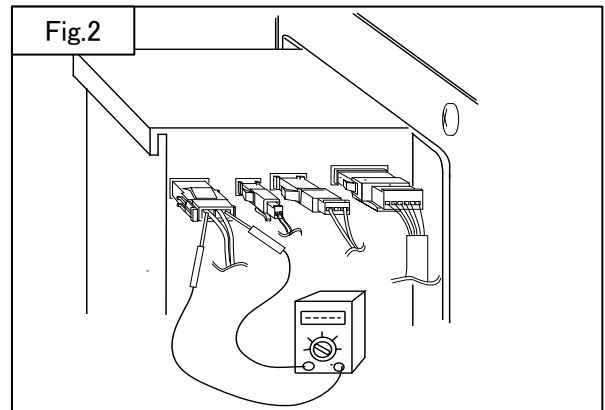

【Check 3】 Check the Resistance at the Coil of Compressor (Fig.3)

◇Checking point

- Remove 2 pin couplers at motor cord, and check.
(Ambient temp 25°C)

Test result	Assessment
Approx. 0.84 Ω	Normal
∞ Ω	Broken
0 Ω	Coil of compressor is short circuit

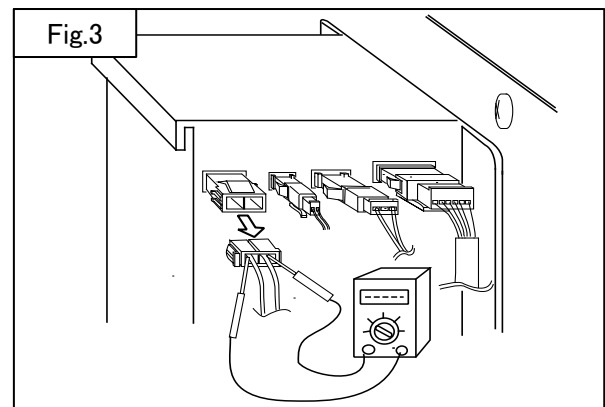

【Check 4】 Resistance of Thermistor (Fig.4)

◇Checking points

- Remove the 3 pin couplers from Inverter, and test.
(Ambient temp 25°C ~ -16°C)

Test result	Assessment
Approx. 2 kΩ ~ 10 kΩ	Normal
∞ Ω	Broken
0 Ω	Short Circuit

Note) When short circuit, motor runs continuously.

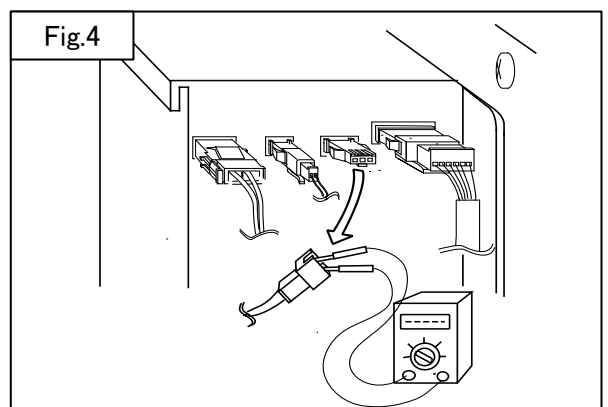

5. CHECKING POINT & METHOD

【Check 5】 Resistance of Control Assy (Fig.5)

◇Checking point

Remove 6pin coupler.

Check the resistance at between terminals brown and black.

Test result	Assessment
Dial position OFF ~ 5	
Approx. 17kΩ ~ 5kΩ	Normal
∞Ω	Broken
0Ω	Short Circuit

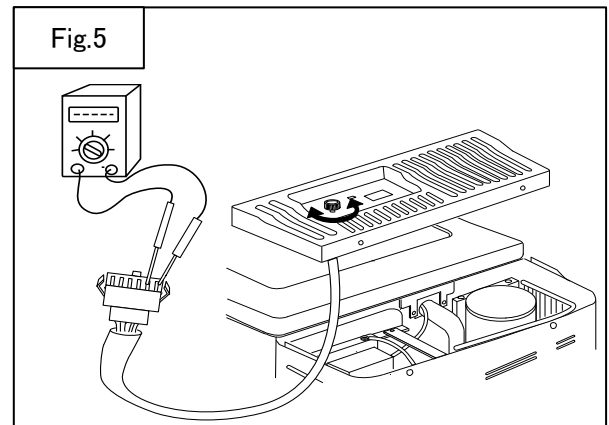

【Check 6】 Check the temperature controller. (Fig.6)

◇Checking points

Check the voltage at between terminals ORANGE and BLACK.

<Use power AC100-240V> (Ambient temp 25°C)

Test result	Judge
Approx. DC12-14V	Normal
DC 0 V	Temperature controller is broken
12V less than	

<Use power DC12V> (Ambient temp 25°C)

Test result	Judge
Approx. DC12V	Normal
DC 0 V	Temperature controller is broken
11V less than	

<Use power DC24V> (Ambient temp 25°C)

Test result	Judge
Approx. DC24V	Normal
DC 0 V	Temperature controller is broken
23V less than	

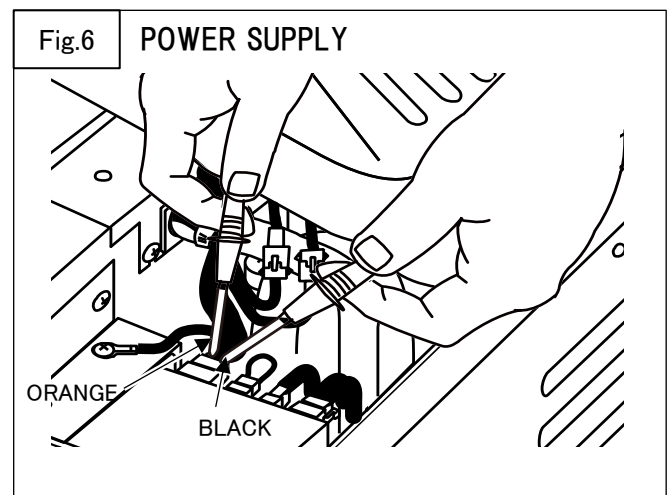

【Check 7】 Checking the operation of the fan motor. (Fig.7)

◇Checking point

If want to check the start-up of the fan motor directly, can check by connecting the DC24V directly. (Fig.7)

⚠ CAUTION

- Please be careful not to mistake the polarity of the power supply.
- When connect with DC24V or wrong polarity, fan motor will fail.
- Please use such as support coupler so as not to short-circuit power.

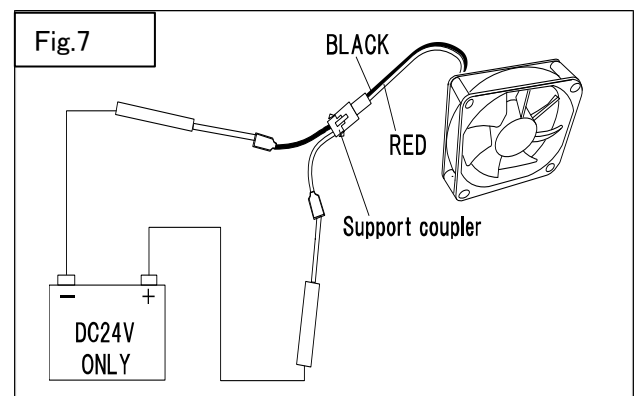

6. PRODCEURS FOR REPLACING

■ How to Replace Cooling Unit

① Remove the motor cover (Fig.1)

* Take out the basket first

(1) Remove 4 screws which hold Motor Cover.

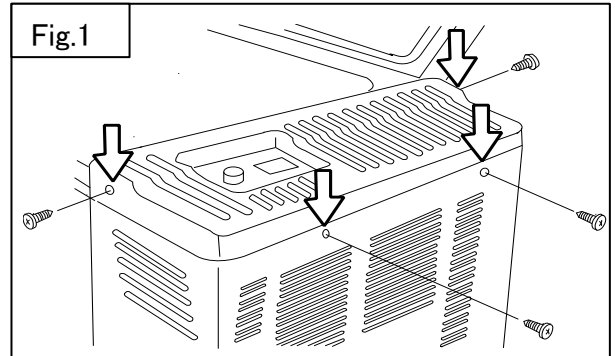

② Pull out all the couplers at power supply. (Fig.2)

(1) Motor input coupler. [1]

(2) Fan motor coupler. [2]

(3) Thermistor coupler. [3]

(4) Control assy coupler. [4]

(5) Fan motor coupler (From refrigerator inside). [5]

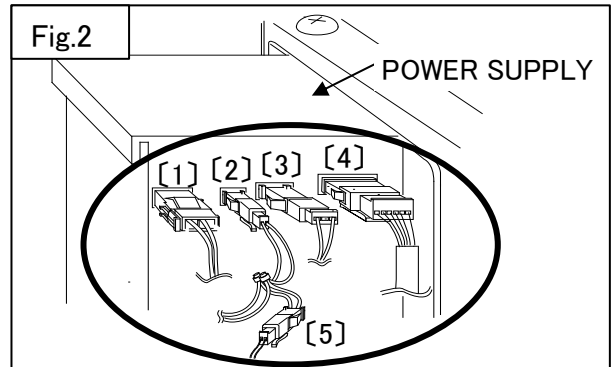

② Remove the cover pipe (Fig.3)

(1) Remove 2 fasteners. [1] (MT80F ONLY)

(2) Remove 2 screws. [2] (MT60F ONLY)

(3) Remove 2 screws and take off the pipe cover. [3]

(4) Detach the rubber grommet. [4]

(5) Cut the fasteners. [5]

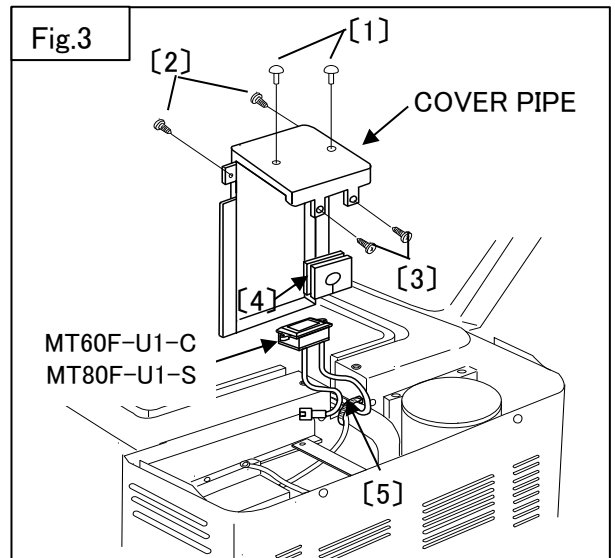

③ Remove the thermistor (Fig.4)

(1) Cut the 2 fasteners. [1]

(2) Remove screw. [2]

(3) Remove the thermistor

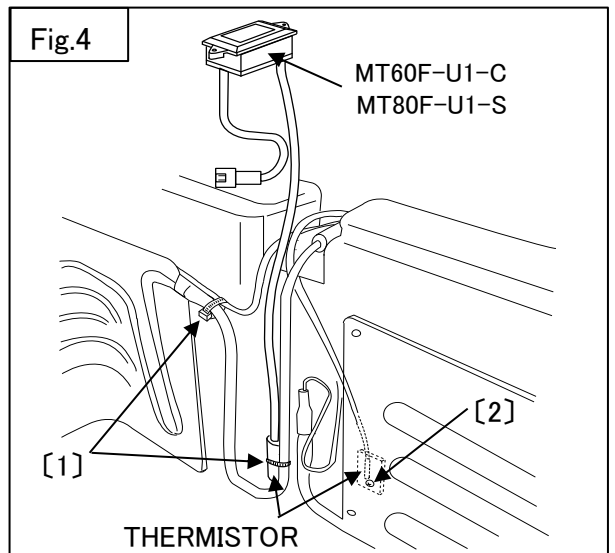

6. PROCEDURES FOR REPLACING

④ Remove screws at the hanger of the compressor. (Fig. 5)

(1) Remove 5 screws. [1]

(1) Remove the earth wire. [2]

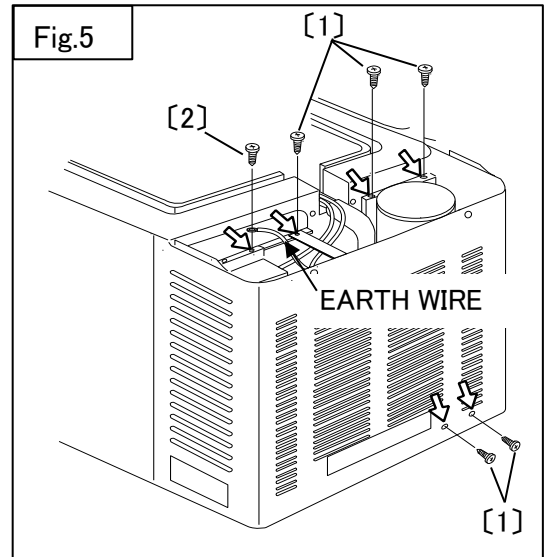

⑤ Remove the cooling unit. (Fig.6), (Fig.7)

(1) Take out cooling unit from the cabinet.

WORK TIPS

Please remove evaporator and capillary tube carefully for not to damage.
In addition, please be careful for not to bend capillary tube.

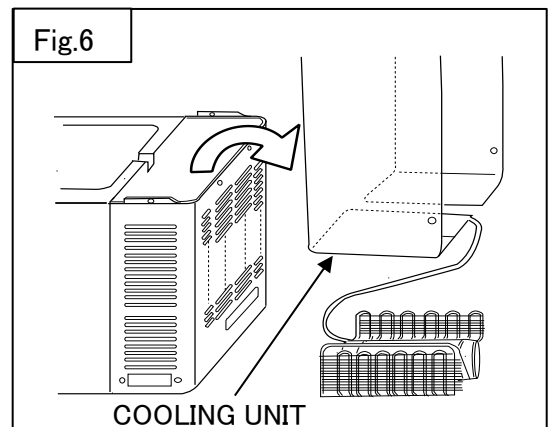

(2) Remove the motor input wire. [1]

(3) Remove the earth screw. [2]

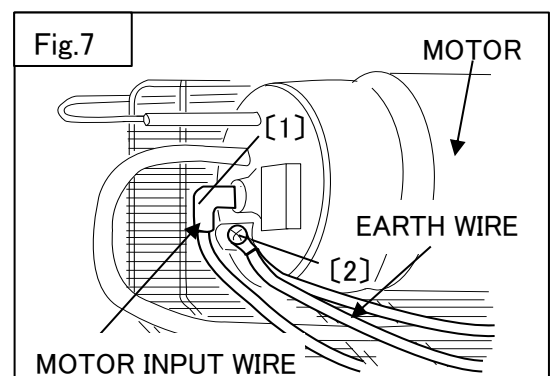

6. PRODCEURS FOR REPLACING

■ How to Replace Power Supply

① Remove motor cover. (Fig.1)

(1) Remove 6 screws.

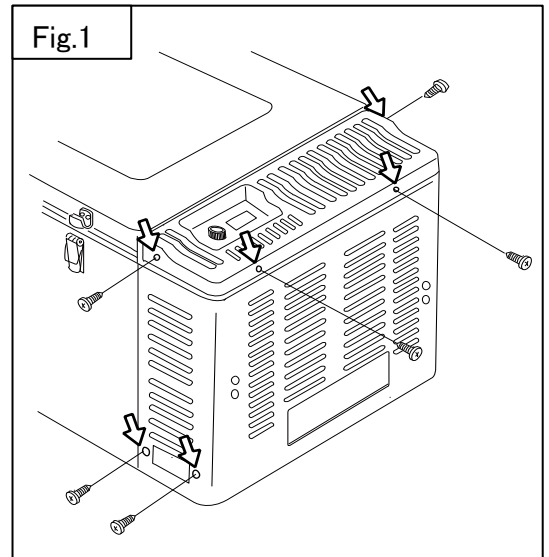

② Pull out all the couplers at power supply. (Fig.2)

- (1) Motor input coupler. [1]
- (2) Fan motor coupler. [2]
- (3) Thermistor coupler. [3]
- (4) Control assy coupler. [4]

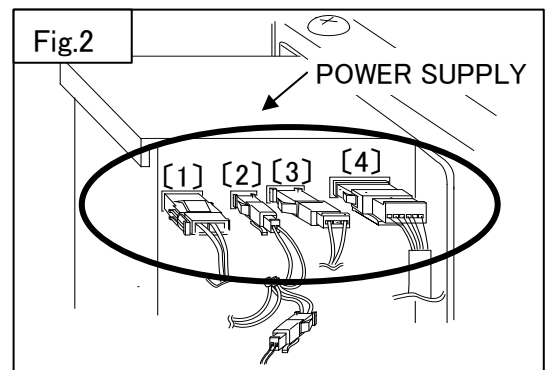

③ Remove the power supply (Fig.3)

(1) Remove 2 screws. [1]

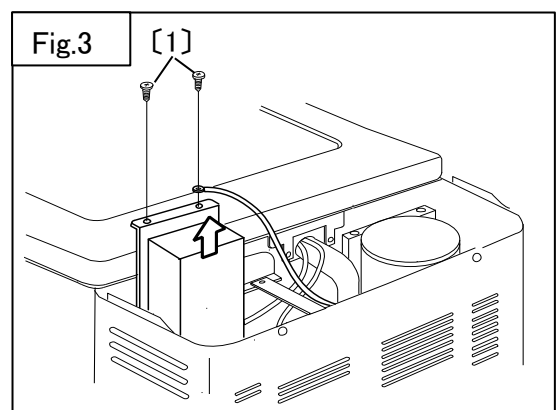

④ Remove power supply from cover. (Fig.4)

(1) Remove 4 screws from power supply plate. [1]

(2) Remove earth wire. [2]

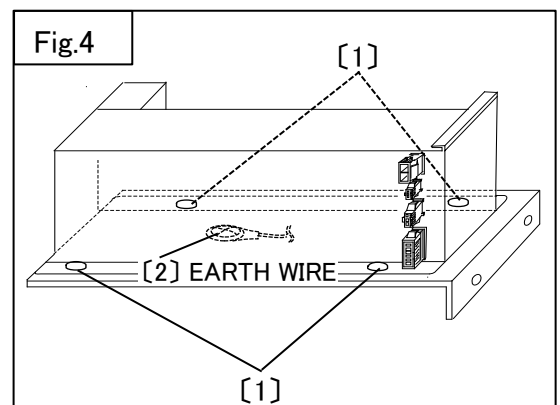

6. PRODCEURS FOR REPLACING

■ How to Replace Control Assy and Degital Thermometer (MT60F-U1-C / MT80F-U1-S)

① Remove the motor cover (Fig.1)

- (1) Remove 4 screws which hold Motor Cover.

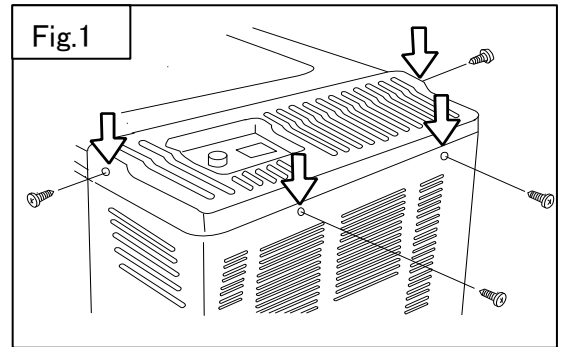

② Remove the control assy and degital thermometer. (Fig.2)

- (1) Remove the dial assy. [1]
- (2) Take off a mark. [2]
- (3) Remove 4 screws. [3]
- (4) Remove the coupler connection. [4]

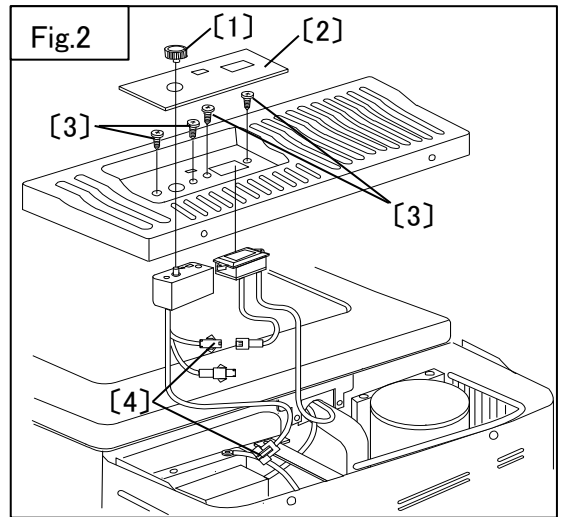

③ Take out cover pipe (Fig.3)

- (1) Remove 2 fasteners. [1](MD80F ONLY)
- (2) Remove 2 screws. [2] (MD60F ONLY)
- (3) Remove 2 screws and take off the pipe cover. [3]
- (4) Detach the rubber grommet. [4]
- (5) Cut the fasteners. [5]

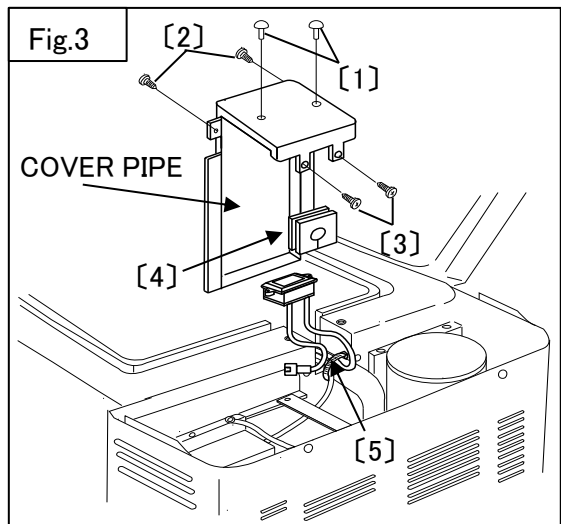

④ Take out thermistor (Fig.4)

- (1) Cut the fasteners. [1]

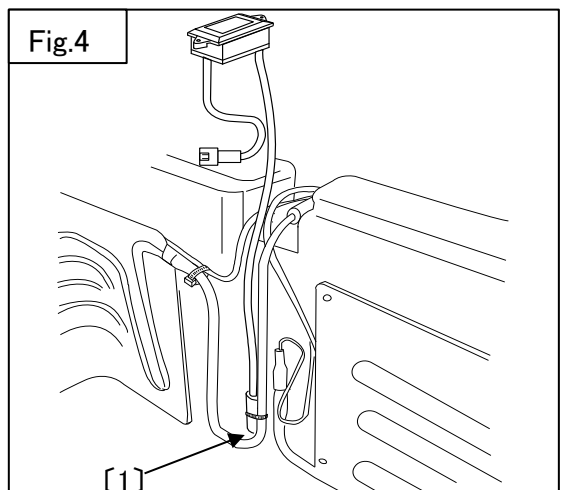

6. PRODCEURS FOR REPLACING

■ How to Replace Fan Motor

<Compressor side>

- ① Remove the cooling unit. (See page 13)
- ② Remove the fan motor. (Fig.1)
 - (1) Remove 2 screws. [1]

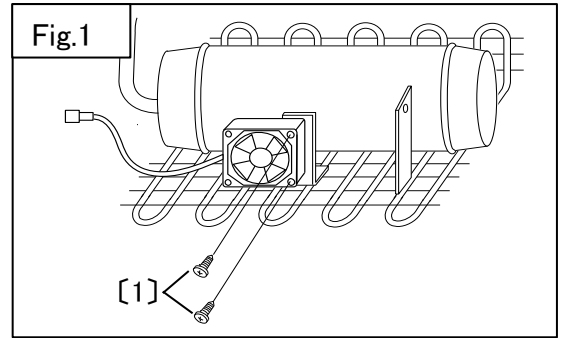

<Refrigerator inside> (MT60F-U1-C)

- ① Remove the cooling unit. (See page 13)
- ② Remove the fan code. (Fig.1)
 - (1) Remove the screw from the clamp. [1]
 - (2) Remove the sponge seal. [2]

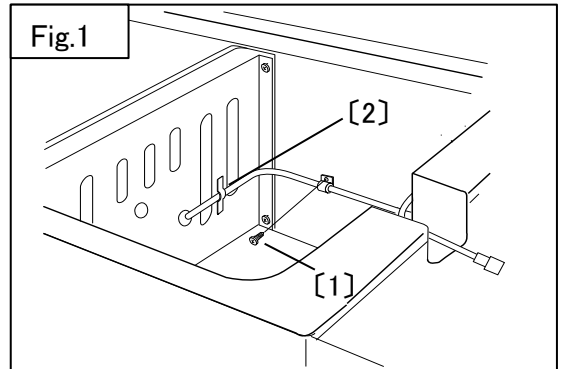

- ③ Remove the fan cover. (Fig.2)
 - (1) Remove 5 screws. [1]
 - (2) Remove 4 fasteners. [2]

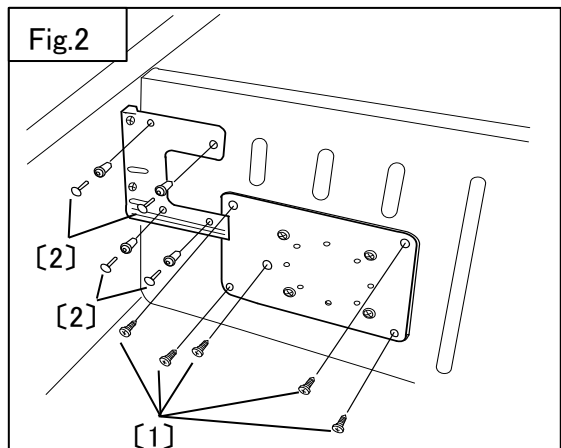

- ④ Take out fan motor (Fig.3)
 - (1) Remove 2 screws. [1]
 - (2) Remove 4 screws. [2]

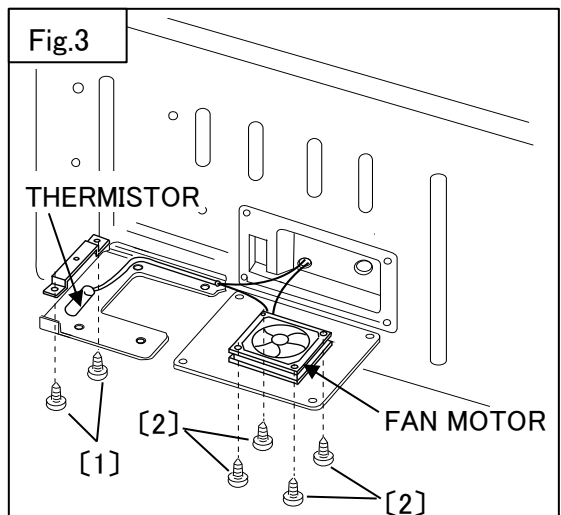

SAW  FUJI